

Project:	Catalog:	Type:
Notes:		

Product Description

The CRTW series provides serviceability from walkable composite ceilings. Installed within and supported by a finished composite ceiling system of thicknesses of 2, 3 or 4 inches. Rated for 800lbs static load without fixture damage. An overlapping gasketed door frame seals the room at the ceiling. Gaskets are also provided at the lens and top cover to prevent dust, liquid or vapor penetration. It is UL Listed for wet locations, cleanroom rated ISO-3, certified dust tight and water resistant to IP65 for frequent rigorous cleaning practices. Tested according to ASTM-72 and E2322 for strength and load resistance.

Feature Options

- Up to 25000 lumens
- Convenient Lift Handles
- Ceiling Compatibility 2"- 4" Thick
- Serviceable from above

Common Options*

- Emergency Battery Backup Options**
- Optional 90 CRI



Housing

Precision formed and welded 16 gauge cold rolled steel housing. Single top surface located knockout for power entry. See options for additional material choices. Closed cell neoprene gasket provided to seal flange to ceiling.

Access Door

Inset, one-piece access door, fabricated from 16 gauge cold rolled steel with TIG welded corners. Neoprene gasket seals access door to housing. Reinforced with welded structural brackets to support walking loads. Regressed handle provided as lifting point.

Lens Frame

Overlapping one-piece door frame, fabricated from 18 gauge, cold rolled steel with TIG welded corners. High performance Poron™ gasket seals door frame to housing and ceiling.

Lens

High diffusion, impact resistant 0.125" thick acrylic lens provides symmetric distribution. Smooth external surface for easy cleaning. Other lens options available. (See Ordering Key). No roomside hardware. (Electronics not intended to be serviced from the cleanroom side).

LED

LED board modules are high efficiency and closely regulated to maintain CRI, color consistency, lumen performance and efficacy. Select from 3000K, 3500K, 4000K and 5000K color temperatures with a color consistency of 3 SDCM, standard 80 CRI, optional 90 CRI. Optional Amber LED arrays available alone or in combination with white LEDs. Lifetime L70 is greater than 60,000 hrs. Modules are field replaceable and commercially available.

Electrical

The standard electronic driver is constant current, programmable and dimmable to 1% using a 0-10V protocol. High efficiency (>85%) and low THD (<10%). Meets requirements of FCC Part 15. 120-277Vac or 347Vac, 50/60hz. See "Options" for Lutron™ or DALI driver choices. Internal Emergency Drivers are serviceable from the walkable ceiling.

Finish

Standard finish is gloss white polyester powder coating with 5-stage pre-treatment. Optional Anti-microbial gloss white polyester powder coat finish with 5-stage pre-treatment. Satin polished #4 brushed finish available for stainless steel doorframes.

Mounting/Installation

Installed in precut holes within ceiling panels of 2, 3 or 4 inches thickness. Conduit entry thru ½" trades-size conduit access hole. (See chart for ceiling cutout details).

Certifications

ETL Certified for recessed ceilings and wet locations under covered ceiling. Recessed Type non-IC ceilings. NSF2 for Non-food zone, Splash Zone. IEC60598 IP65 Certified from below. IP6x from above. Cleanroom classified ISO3-8.

Warranty

5 year limited warranty. For complete warranty, click here:



Approvals

- UL Certified for recessed ceilings and wet locations
- Certified IP65 and NSF2
- Cleanroom class ISO3-8



Dimensions

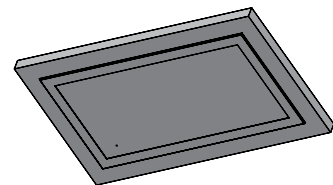
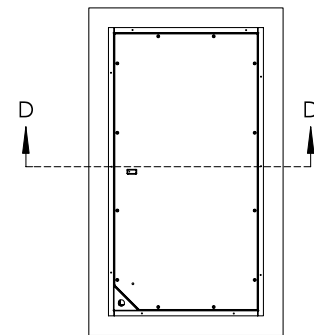
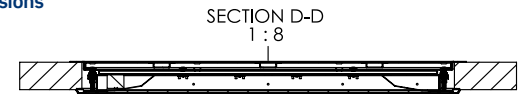

Ceiling Cut-Out Dimensions (Inches)		
Size	Width	Length
1x4	14.25"	50.25"
2x2	26.25"	26.25"
2x4	26.25"	50.25"

Consult installation guide for exact dimensions.

*This fixture is not intended for use in refrigerated or frozen spaces.
**Consult factory for location of emergency drivers in 2x2 size fixtures

Project:	Catalog:	Type:
Notes:		

Order Key

Example: CRTW02X4A/B-LED840K70LUNV-2T-DSA

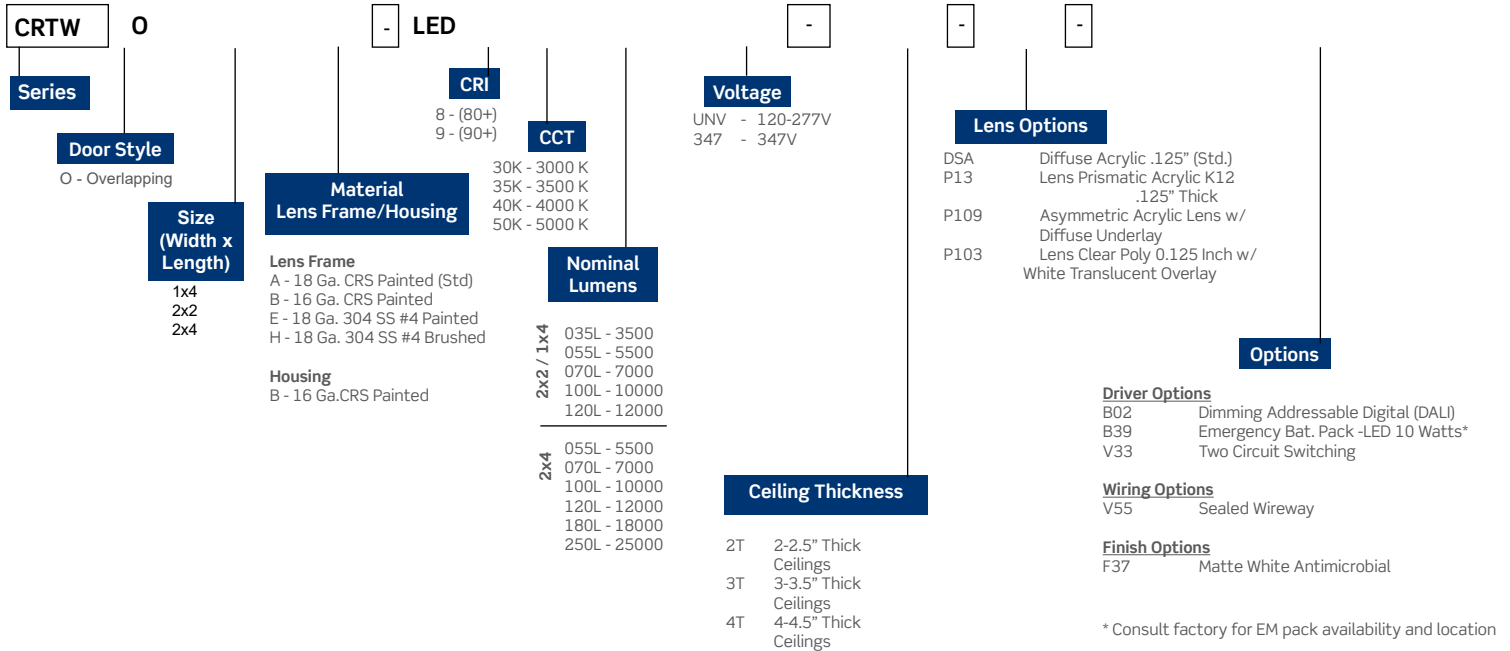

* Consult factory for EM pack availability and location

CRTW Performance Chart				
Size	Order Code	Lumens (4000K)	Watts	Efficacy
1x4	035L	3501	28	125.0
	055L	5503	41	134.2
	070L	7003	52	134.7
	100L	10004	75	133.4
	120L	12194	90	135.5
2x2	035L	3557	26	136.8
	055L	5589	40	139.7
	070L	7113	51	139.5
	100L	10161	73	139.2
	120L	12180	88	138.4
2x4	055L	5601	41	136.6
	070L	7128	52	137.1
	100L	10183	74	137.6
	120L	12220	89	137.3
	180L	18330	135	136
	250L	24929	178	137