

Project
Type
Date
Cat #

Application Features

Specification-grade, surface-mounted wall-wash luminaire. For use with indoor applications such as in institutions, retail stores and supermarkets where wall-mounted displays or visual information boards require external illumination.



Specifications

Optical System

Solid white reflectors are standard. Optional reflectors are available in specular aluminum with a minimum reflectance of 95%.

Mounting

Mounting holes are provided. Knock-outs are provided for stem-mounting. Optional stem and canopy sets are available in multiples of six inches.

Construction

Die-formed and spot welded, heavy-gauge steel housing assembly. Flattened knockouts are provided on ends for through wiring.

Finish

White, polyester powder painted housing. High-reflectivity coated reflecting surfaces for improved efficiency.

Electrical

Rotary lampholders ensure positive lamp retention. Sufficient knockouts are provided for connections and through wiring.

Approvals

Approved to CSA and UL standards.

Features

- Ideal for lighting chalk boards, white boards or wall mounted displays
- Available with 1 or 2 lamps (T5 and T8 configurations)
- High reflectance internal reflector
- Available in lengths from 24 to 96 inches
- Continuous row-mounting capability

Options & Adders

- Enhanced specular aluminum reflector with a minimum reflectance of 95%
- Dimmable and Emergency ballast
- Radio interference filter (120V - 277V)
- Stem and canopy sets
- 20 gauge heavy-duty construction
- Pull chain switch

Applications

- Billboards
- Classrooms
- Displays
- Retail Stores and Supermarkets

Dimensions

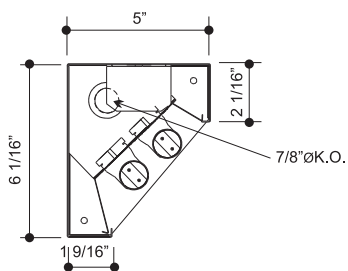

Cross Section

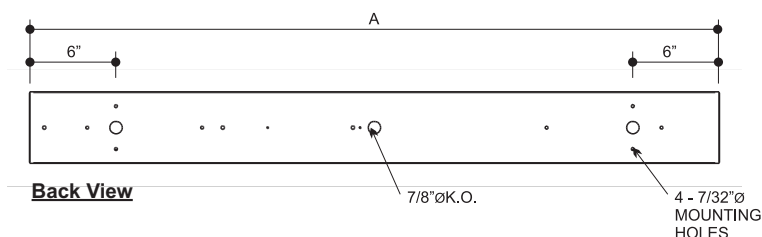

Back View

MODEL	NOMINAL LENGTH	A
124	24"	24 1/4"
224		
136	36"	36 1/4"
236		
148	48"	48 1/4"
248		
136/2	72"	72 1/4"
236/2		
148/2	96"	96 1/4"
248/2		

Project
Type
Date
Cat #

WW Wall Wash

Specification-Grade Surface-Mounted Wall Wash Luminaire



Photometrics - Please consult www.viscor.com for photometric results.

Ordering WW - - Options

Typical Number of lamps in Cross Section

1
2

Nom. Length (in.)

24
36
48

Lamp Watts
See Table below

Lamp Type
T5
T5HO
T8

Voltage
120 - 120V
347 - 347V
UNV - 120-277V
UN4 - 347-480V

Ballast Type
N - Instant Start
P - Program Start
R - Rapid Start

Tandem
(Blank) - N/A
/2 - Single Housing

Ballast Options

(See Option Code Section For More Information)

- ☐ B02 Dimming Addressable Digital (dali)
- ☐ B03 Dimming Low Voltage (0-10)
- ☐ B04 Dimming Line Voltage
- ☐ B08 Ballast - High Ballast Factor
- ☐ B09 Ballast - Low Ballast Factor
- ☐ B30 Emergency Lighting Battery Pack Specification Grade
- ☐ B33 Emergency Lighting Battery Pack 1-lamp
- ☐ B34 Emergency Lighting Battery Pack 2-lamp

Housing Construction Options

- ☐ C07 Housing 20 Gauge Welded

Finish Options (white is standard)

- ☐ F01 Black

Packaging Options

- ☐ K0 Pack Bulk/ Pallet Packed and/or Wrapped

Mounting Options (select one only)

- ☐ M26(xx) Mounting Stem & Canopy Set 3/8" NPT (5/8" OD) (specify length (xx) 6-in increments)
- ☐ M29(xx) Mounting Stem & Canopy Set For Sloped Ceilings 3/8" NPT (5/8" OD) (specify length (xx) 6-in increments)

Reflector Options (white is standard)

- ☐ VF1 Reflector VF1 Solid Full (95% Reflectance) Specular

Switch Options (select one only)

- ☐ S1 Switch Pull-chain

Fusing and Breaker Options (select one only)

- ☐ T5 Fuseholder, In-line Double Pole
- ☐ T6 Fuseholder, In-line Single Pole

Wiring Options

- ☐ V25 Radio Frequency Filter

Approval and Rating Options

- ☐ X7 Dual CSA and USA Markets

Example:

WW248-T832PUNV-B01C07S1

Lamp Watts

Length	Nominal Lamp Watts		
	T5	T5HO	T8
24	14	24	17
36	21	39	25
48	28	54	32

Other options may be available consult factory.
Specifications and data subject to change without notice.

INSTITUTIONAL LIGHTING